

Pneumatic Riveter
R1A1

Achievement by Air Riveter, that is made in Japan



Parts made in Japan to secure a stable supply!!



The main unit and parts of the Air Riveter R1A1 are made in Japan. We can provide a commitment to stable parts supply. Prices of expendable parts which are frequently replaced are clearly defined in an easy-to-understand manner.

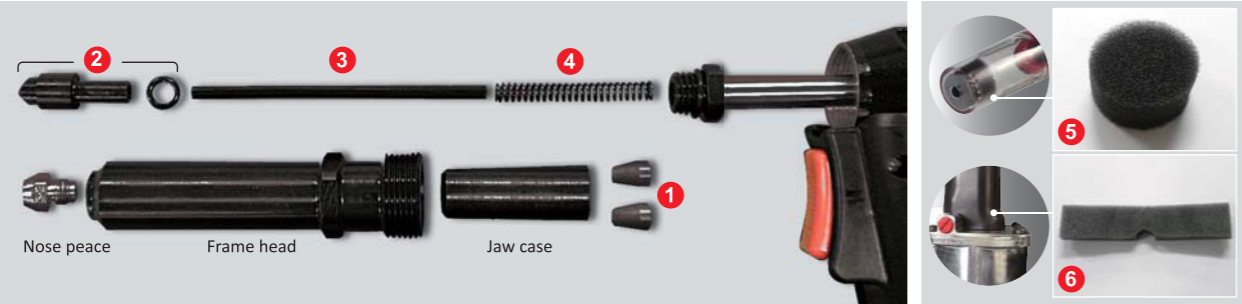

R1A1 parts

Model name		Model code number (model number)	Product name
R1A1	①	J1	LOBSTER Riveter Jaw (P) No.1 (J1)
	②	63219	Jaw pusher (with P6 O-ring)
	③	63218	Guide tube
	④	63222	Jaw pusher sprig
	⑤	63252	Tank case sponge
	⑥	63253	Sound-deadening sponge

• LOBSTER Riveter Jaw (P) No.1 (J1) is a special jaw developed for the R1A1. The LOBSTER Riveter Jaw features higher strength and resistance when compared with existing jaws (JS, JM, and JL), has the same performance capability as super hard jaws, and provides superior cost performance.

Note The conventional jaws (JS,JM,JL,CJM,CJL) can not be used with R1A1.



Warning •Make sure to attach the tank unit before use. In addition, wear protective goggles during use.

Note The rivets in this catalog applies to our blind rivet.These sizes may not correspond to the blind rivets manufactured by 3rd party companies. For details, please contact your dealer.

Caution for secure usage Be sure to read the enclosed Instruction Manual carefully and make sure that you understand them thoroughly before using this tool.



LOBTEX CO.,LTD.

International Marketing Group
TEL+81(72)981-7466 FAX+81(72)981-9420
12-8 Shijo-Cho,Higashi-Osaka City,Osaka 579-8053 Japan
URL : www.riveter.com www.lobtex.co.jp/

No.10K-10000TO



Pneumatic Riveter R1A1

PNEUMATIC
Riveter
CHONMAGE

MADE IN
JAPAN

R1A1

Advanced top-class standards

The Air Riveter R1A1 - developed using the comprehensive technology of LOBSTER with the high quality and safety that's trusted by professionals around the world. Featuring best-in-class lightweight design. The main body and all associated parts are made in Japan. It's the beginning of the Air Riveter legend. Advancement starts here.



Lightest-in-class!! Middle-class (M) type

1090g best-in-class lightweight design makes it easy for anyone to use, even for extended periods.

1,090g

R1A1



1,350g

AR2000MV



Compact size and long stroke!!

Equipped with a middle-class stress-free 19-mm long stroke. Dramatically improved efficiency requiring less double-taps than before



R1A1



16mm

AR2000MV



R1A1 achieves up to a 55 % reduction in air consumption (compared with company B)

When using 1200 rivets per day (8 hours) for 20 days a month

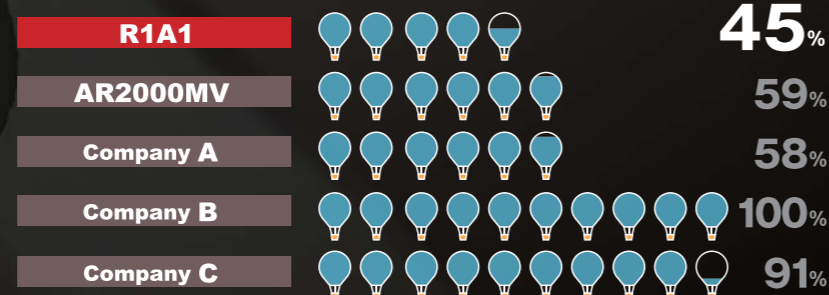

Best cost advantage!

Shave off up to **24,466 yen** from your yearly electricity costs!! (compared with company B)

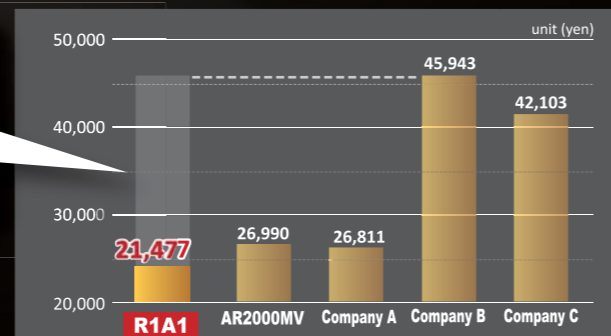

● 当社調べ

*: Cost cut of 5,513 yen, compared with AR2000MV (LOBTEX)



Thin Frame Head

By utilizing dedicated jaws,φ19.5mm thin frame head can be realized. Suitable for riveting in a narrow space.



1090g, best-in-class lightweight design

Designed to ease the burden of the worker, constructed from plastic and aluminum to achieve smart and compact external dimensions and reduced weight. The center of gravity is located around the grip, to achieve a lighter feel.



The resin grip which makes it easy to grip

Features a body with a natural curve that comfortably fits in the palm of your hand. Comfort grip shape.



Air intake with changeable left/right direction

The direction of the air intake can be changed between left and right depending on your work. Change with ease, depending on the use and shape of your air hose.



High-power design

Lightweight and compact size, yet powerful. Supports stainless 4.8
Traction Power : Vacuum ON : 9.0 kN (918Kgf)
Vacuum OFF : 10.0 kN (1,020 Kgf)

※Air pressure at 0.59 Mpa



Utilizes a long stroke of 19 mm

Sufficient long stroke with compact size



On-board vacuum on/off switch

You can switch Vacuum on/off according to the work being performed. Turn the vacuum on to increase work efficiency. Turn the vacuum off to increase power. This reduces compressor power consumption.



Reduced air consumption of approx. 25 % compared with our conventional model (AR2000MV)

Air circuitry and parts thoroughly optimized for environmental friendliness. Reduced vacuum air consumption that reduces compressor power usage.



R1A1[Air Riveter] Dimension

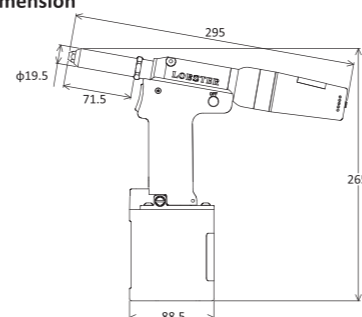

Model number	Weight (g)	Used air pressure: Mpa(kgf/cm ²)	Traction Power*1 kN(kgf)		Stroke (mm)	Air consumption (L/min)	Noise emission (dB)
			Vacuum ON	Vacuum OFF			
R1A1	1,090	0.49 to 0.59 (5 to 6)	9.0 (918)	10.0 (1,020)	19	68 ^{*2}	69.5 ^{*3}

*1: Air pressure at 0.59 Mpa

*2: Air pressure at 0.49 Mpa

*3: The value shall be based on LOBTEX standard.

Riveting Capacity (φmm)	2.4	○	Specifications/ device	Air control	Air valve type
	3.2	○		Anti-shock	○
	4.0	○		Air intake	Left and right (interchangeable, vertical orientation possible) /with Rotary joint
	4.8	○		Integrated Vacuum System	○ (with Tank case)/ with Vacuum on/off Switch
				Jaws	Dedicated jaws No. 1 (J1)