



H.C.B-A1409

DAF XLR (Euro 4) PROPELLER SHAFT

CENTER BEARING NUT SOCKET

Dr. 3/4"

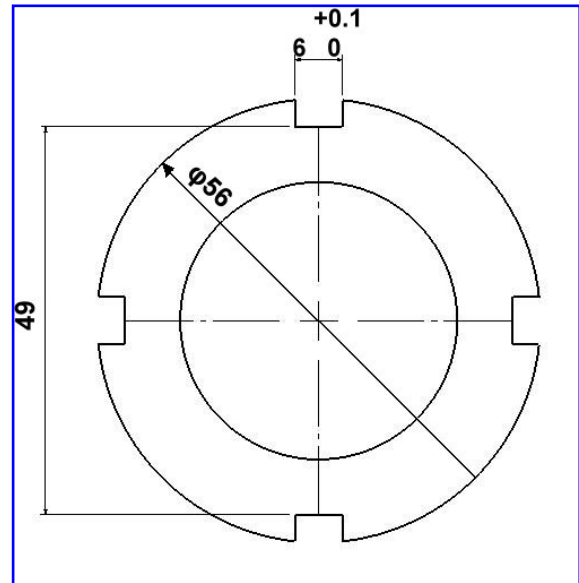
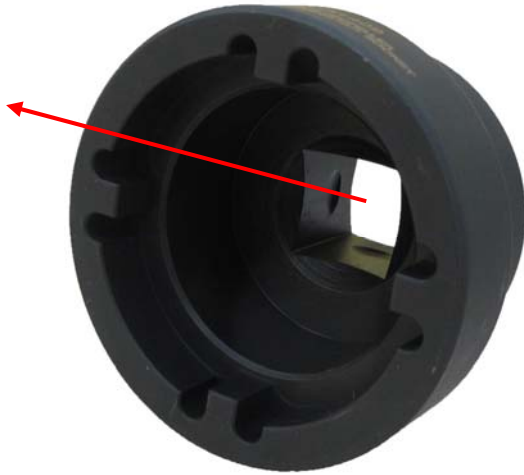

- To remove and install the nut of propeller shaft center bearing when bearing is broken.
- The robust socket is manufactured from a piece of material.
- Material : SCM440 Net Weight: 0.786 kgs.
- It can be used with torque wrench for installing and removing about 350 N.m.
- Application: DAF XLR (Euro 4) Truck