

H.C.B-A1170

INSTALLATION :

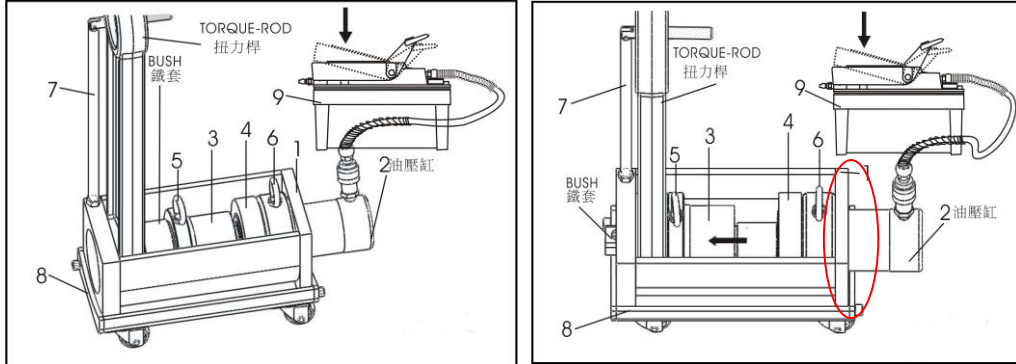

* Keep stepping on the foot plate of air lock until the independent totally combined with Torque-Rod. (Without obstructing the working process of air pump)

INSTALLATION FINISHED :

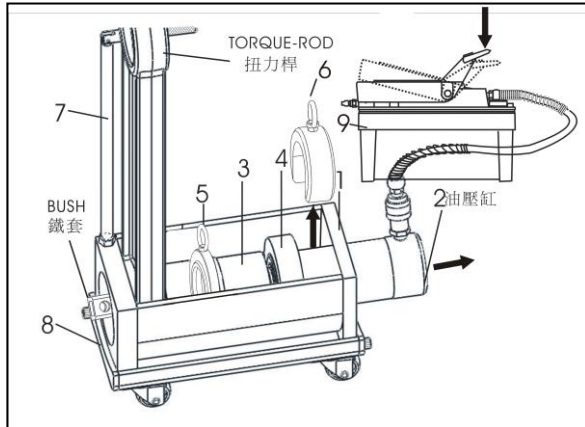

* As it finished, releasing the pressure to take the #6 away and pull the cylinder back, so the Torque-Rod can be got out easily.

H.C.B-A1170 TRUCK TORQUE-ROD BUSH REMOVAL / INSTALLATION

PAT.M 307531



CLEANING HOLE

NO.	Description
A1170-1	MAIN BODY L358XW160XH151(m/m)
A1170-2	30 TON HYDRAULIC CYLINDER (STROKE 130mm)
A1170-3	Φ103X98L RING PIVOT
A1170-4	Φ138X35L NUT (FIXED ONTO HYDRAULIC) (M88XP2.0)
A1170-5	INSERTION SUPPORT SLEEVE (Φ138X30L)
A1170-6	C-SHAPE FIX BASE
A1170-7	TORQUE-ROD LOCK BAR (M14XP2.0)
A1170-8	TRAILER (L375XW180XH110mm)
A1170-9	AIR PUMP (OIL RESERVOIR CAPACITY 1,600 C.C.)
A1170-10	SPACER RING

* CLEANING HOLE : Clean the cinder, mud and uncleanness out.

H.C.B-A1170

SPECIFICATION :

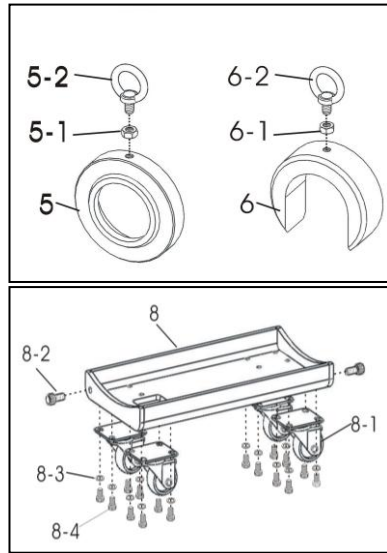
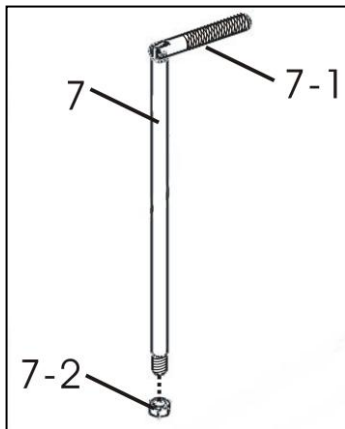
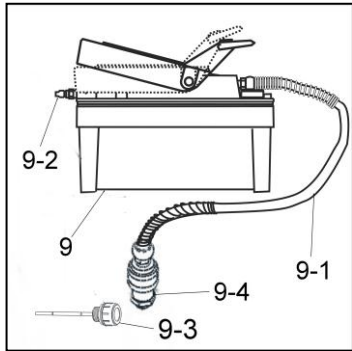
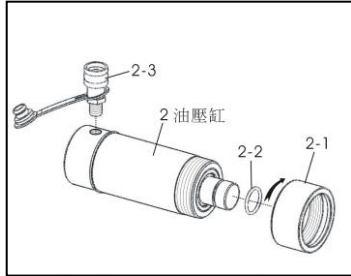

NO.	Description	QTY
A1170-1	MAIN BODY L358XW160XH151(m/m)	1
A1170-2	30 TON HYDRAULIC CYLINDER (STROKE 130mm)	1
A1170-2-1	SCREW THREAD PROTECTOR(M88XP2.0)	1
A1170-2-2	4033 O-RING	1
A1170-2-3	3/8" NPT QUICK COUPLING	1
A1170-3	Φ103X98L RING PIVOT	1
A1170-4	Φ138X35L NUT (FIXED ONTO HYDRAULIC) (M88XP2.0)	1
A1170-5	INSERTION SUPPORT SLEEVE (Φ138X30L)	1
A1170-5-1	NUT (M10XP1.5)	1
A1170-5-2	RING BOLT (M10XP1.5)	1
A1170-6	C-SHAPE FIXI BASE	2
A1170-6-1	NUT (M10XP1.5)	2
A1170-6-2	RING BOLT (M10XP1.5)	2
A1170-7	TORQUE-ROD LOCK BAR (M14X92.0)	1
A1170-7-1	GRIP	1
A1170-7-2	NUT (M14XP2.0)	1
A1170-8	TRAILER (L375XW180XH110mm)	1
A1170-8-1	2" MOVABLE WHEEL	4
A1170-8-2	MAIN BODY FIXED NUT (M8XP1.25)	2
A1170-8-3	SPRING WASHER	16
A1170-8-4	SCREW (M8XP1.25)	16
A1170-9	AIR PUMP (OIL RESERVOIR CAPACITY 1,600 C.C.)	1
A1170-9-1	OIL HOSE (150cm)	1
A1170-9-2	1/4" NPT QUICK COUPLING ADAPTER	1
A1170-9-3	OIL TANK LEVEL GAUGE	1
A1170-9-4	3/8" NPT QUICK COUPLING ADAPTER	1
A1170-9-5	HEXAGONAL PLASTIC SCREW	1

H.C.B-A1170

PREPARATION FOR INSTALLATION :

Clean the Torque-Rod and lubricate the bush before installation.

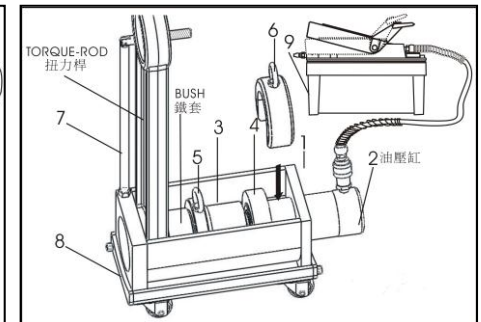
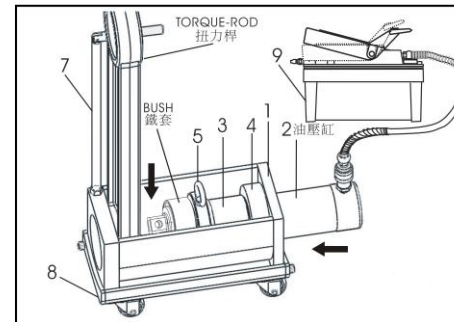
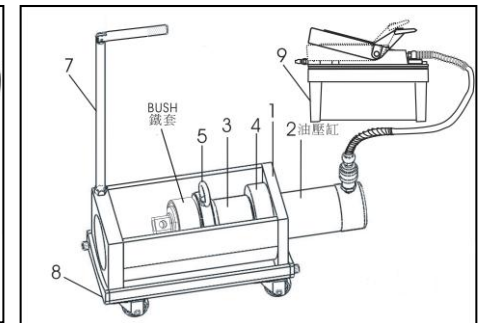
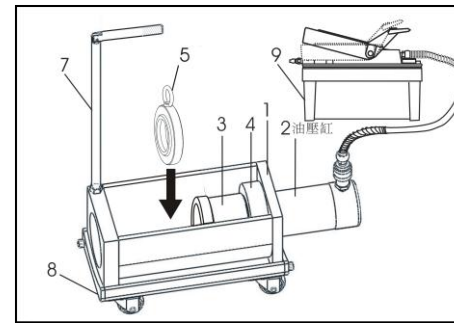

- 1) To cap over #3 with #5.
- 2) Put the bush into the main body and make a close-fitting with #5.
- 3) Put the Torque-Rod into the main body and push #2 forward for tightening all the accessories, put #6 onto the part of inside cylinder.

H.C.B-A1170

REMOVAL :

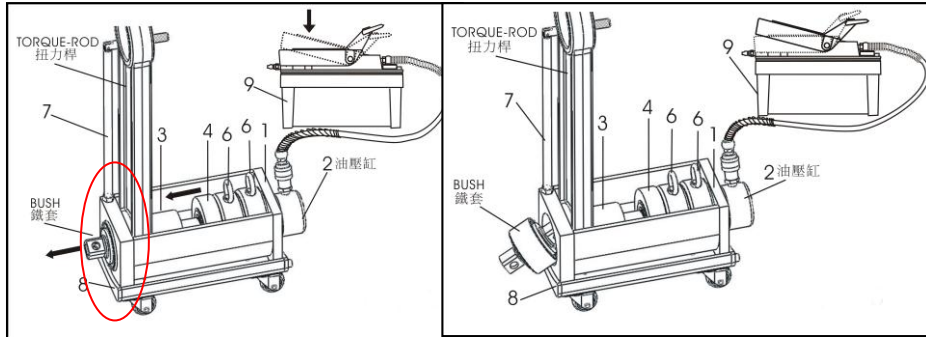

- 1) Firstly, the inspection of fitting bush into the port.
- 2) Keep stepping on the foot plate of air lock until the independent bush comes out. (Without obstructing the working process of air pump)

REMOVAL FINISHED :

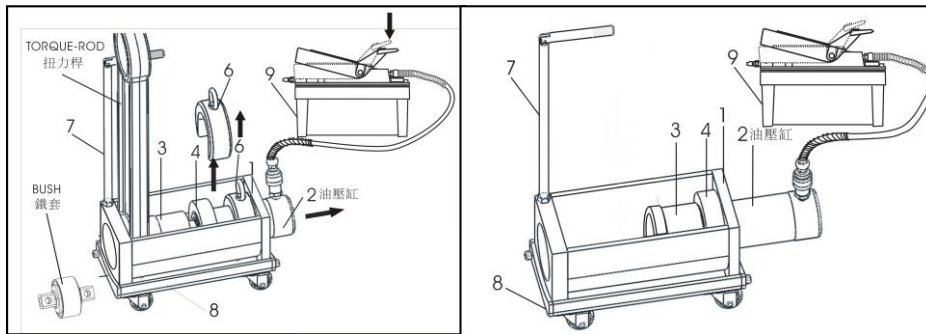

- * As it finished, releasing the pressure to take the #6 away, and pull the cylinder back, so the Torque-Rod can be got out easily.

H.C.B-A1170

! Warning Before Using the Air Pump

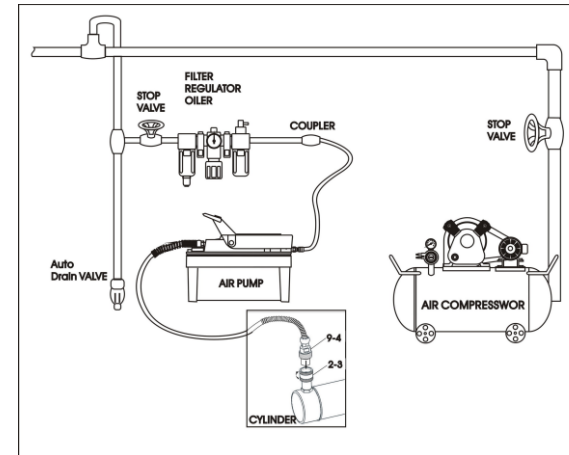

With the Filter Regulator Oiler Brought into Waterproofing. Failure to obey this instruction may decrease the life of inside component or accessories and serious injuries.

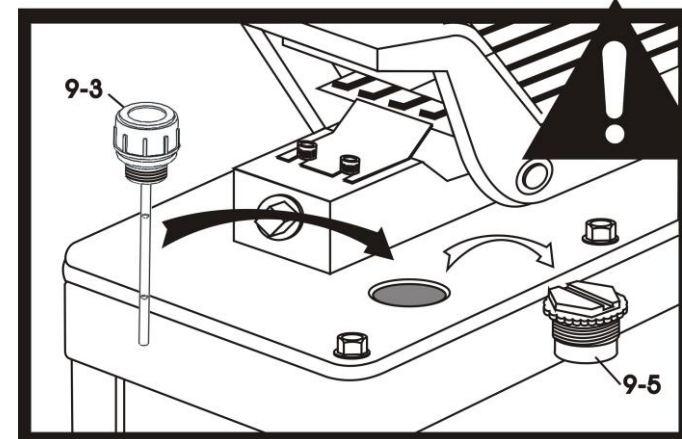

Notice
Before change the A1170-9-5 Screw for A1170-9-3 Oil Tank Level, have to disconnect the pump from air supply.

H.C.B-A1170

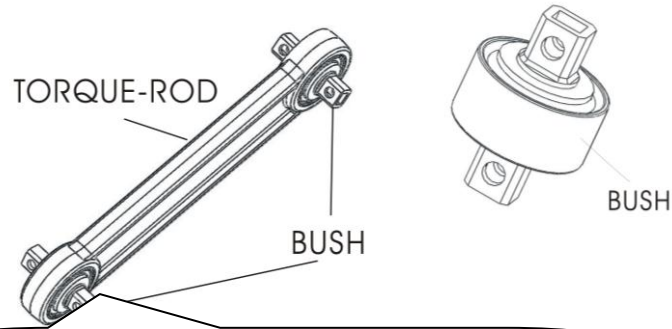

APPLICATION :
EUSO/ISUZU/HINO/NISSAN DIESEL TRUCK

PREPARATION FOR USING ACCESSORIES

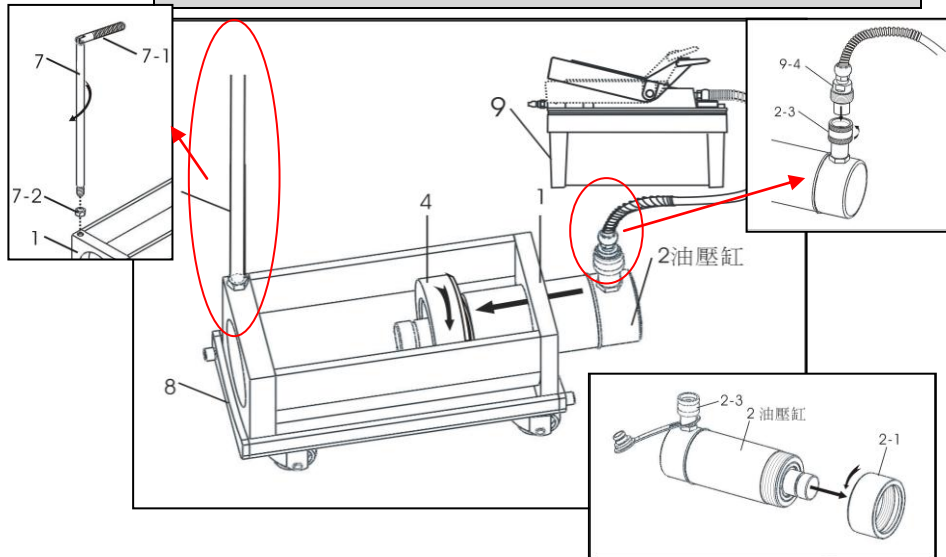

- 1) Move #7-1 revolving around #7 to be locked into #1.
- 2) Separate #2-1 from #2, then put #2 pass through annular port of #1.
- 3) Operate #2-3 in conjunction with #9-4.
- 4) Lock #4 into #2 (turn advance angle in the direction of #2).

H.C.B-A1170

PREPARATION FOR REMOVAL :

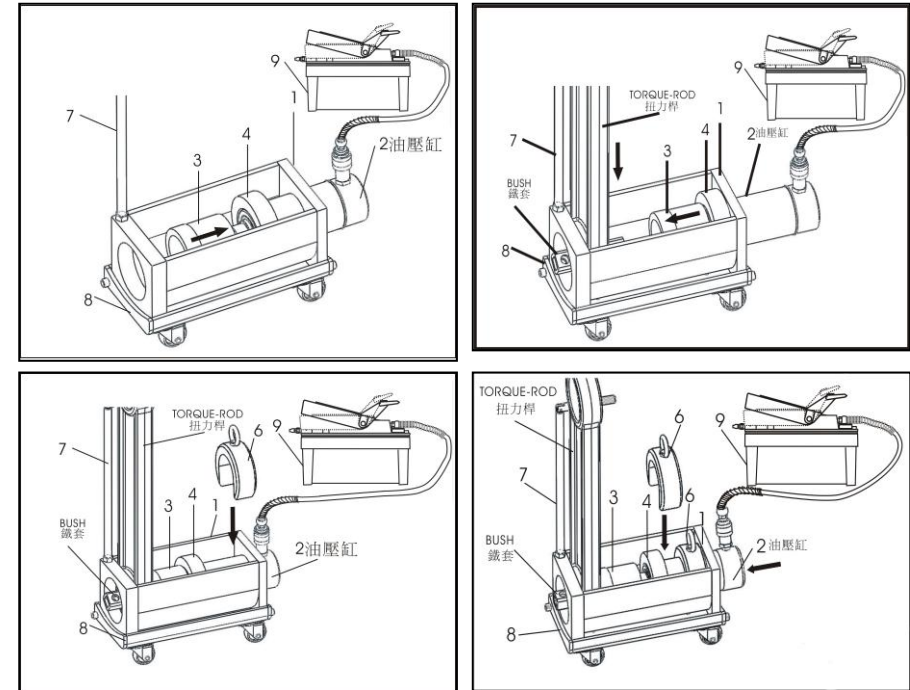

- 1) Installation of #3, turn the narrower port in the direction of #2.
- 2) Put Torque-Rod in the main body close the gap between Torque-Rod & #3. Put #6 onto part of inside cylinder.